

Project Report

Tschuggen Bergoase, Arosa



The eight light sails – a construction made of steel and glass.

Conception

The new wellness and spa area of the Tschuggen Bergoase in Arosa was designed by the architect Mario Botta. The greater part of this new building disappears somewhat into the mountain. The only visible elements are the skylights, which are up to 13 meters in height and are intended to resemble trees. The green roof build-up is an inverted roof with the thermal insulation placed above the roof

waterproofing.

A Floradrain® FD 25-RV drainage element is installed on a water-resistant filter sheet.

A wooden construction resembling an "avalanche support" was built as shear resistance for the steep roof areas. The humus layer that had been removed and stored temporarily was used as a vegetation layer and a lawn was sown.

System Build-up

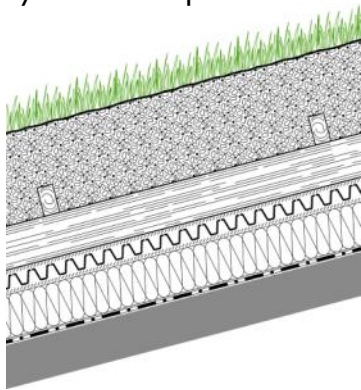

- Lawn cultivation
- Vegetation support layer
- Wooden construction
- Floradrain® FD 25-RV
- Filter Sheet
- Roof build-up with root resistant waterproofing and thermal insulation made of extruded polystyrene

Development



Installing the thermal insulation layer above the roof waterproofing.



Fitting the wooden construction that resembles an "avalanche support".

Project Data

Area: ca. 2.500 m²

Construction Year: 2006

Architect/Design:
ARGE Studio Mario Botta, Lugano and Fanzun AG, Chur

System Build-up:
Inverted Roof with Floradrain® FD 25-RV and grass and herbs

Coordinates:
46°46'40.77"N 9°40'07.75"E



The Tschuggen Grand Hotel in winter.



The light sails, each of them up to 13 metres in height.



The completed green roof.

